



Shipyard Honors



NISI GTX50 Spec Sheet



GTX50 – Exponentially Exhilarating

Our newest model in the XPRESSO series, the first GTX50, was successfully launched and delivered to her owners this past June. Hulls #2 is sold, delivery scheduled for FALL 2014. New build slot reservations are being taken now.

The highly anticipated GTX50 is the first multi-hull to focus on the desires of traditional monohull owners. Drawing on demands from traditional yacht owners and NISI's own megayachts, GTX50's arrival brings unprecedented styling, strength, large social areas, and performance.

Concept and design come from the engineering team at NISI Yachts with naval architecture by Setzer Yacht Architects. Based on established interest from the international yachting community, GTX50's mission is to deliver exceptional and efficient offshore performance with unprecedented exterior and interior spaciousness.

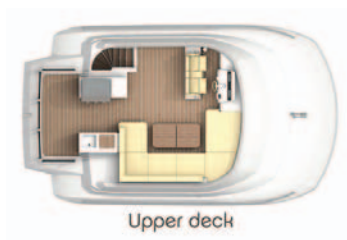

Upper deck



Main deck

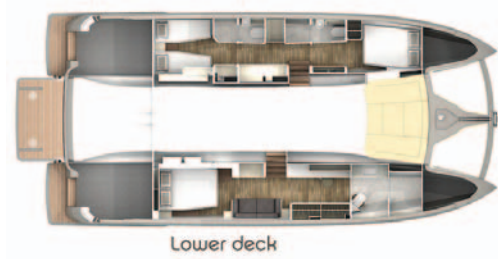

Lower deck

NISI GTX50

General Specifications

LOA	54'
LWL	50'
Beam	23' 9"
Draft - Max	4' 5"
Draft - Light	3' 2"
Beach grounding protection	Yes
Air Draft - w/hardtop	22'
Air Draft - w/fold down	15'
Displacement - Empty	46200
Displacement - Half	50600

NISI GTX50 Spec Sheet



Yacht Performance

Top Speed	32kts
Cruise Speed	28kts
Range: 375nm	26kts
Range: 375nm	9kts
Propulsion	2 x Cummins/Zeus 550hp
Generator	1 x Onan 13.5kw
Build Class	CE and RINA Class (on request)
Concept and Design	NISI Yachts
Naval Architecture	Setzer Yacht Architects
Interior Styling	NISI Yachts